



## WR51 Waveguide Attenuator 15 – 22GHz



Please refer to the mechanical drawing for dimensions.  
Picture is only or illustration purpose only.

### Features

- Waveguide Attenuator.
- 50W Power Handling.

### Typical Applications

- Microwave Test and Measurement
- Radar Applications.
- Military and Defense.

### Electrical Specifications , $T_A=25\text{ }^\circ\text{C}$

Parameters	Min.	Typ.	Max.	Units
Frequency Range	15		22	GHz
VSWR			1.2	:1
Attenuation	3 – 40dB Attenuation Available Upon Request			dB
Forward Power (CW)			50	W
Peak Power (8us pulse)			1	KW
Waveguide Type	Rectangular Waveguide WR51			
Flange type	CPRG, CPRF, COVER, CHOKE, COM'L			
Flange Holes	Through			
Internal Body Finish	Silver Plated chromate or conversion			
External Body Finish	Painted			

**WR51 Waveguide Attenuator 15 – 22GHz**



*Environmental Specifications and Test Standards*

Parameter	Standard	Description
Operational Temperature	MIL-STD-39016	-40°C~+85°C
Storage Temperature		-60°C~+125°C
Thermal Shock		1 Hour@ -45°C → 1 Hour @ +85°C (5 Cycles)
Random Vibration		Acceleration Spectral Density 6 (m/s) Total 92.6 RMS
Electrical & Temperature Burn In		Temperature +85°C for 72 Hours
Shock		1. Weight >20g, 50g half sine wave for 11ms, Speed variation 3.44m/s 2. Weight <=20g, 100g Half sine wave for 6ms, Speed variation 3.75m/s 3. Total 18 times (6 directions, 3 repetitions per direction).
Altitude		Standard: 30,000 Ft (Epoxy Sealed Controlled Environment) Optional: Hermetically Sealed (60,000 ft. 1.0 PSI min)
Hermetically Sealed (Optional)		MIL-STD-883



### Typical Performance Plots

#### Input VSWR

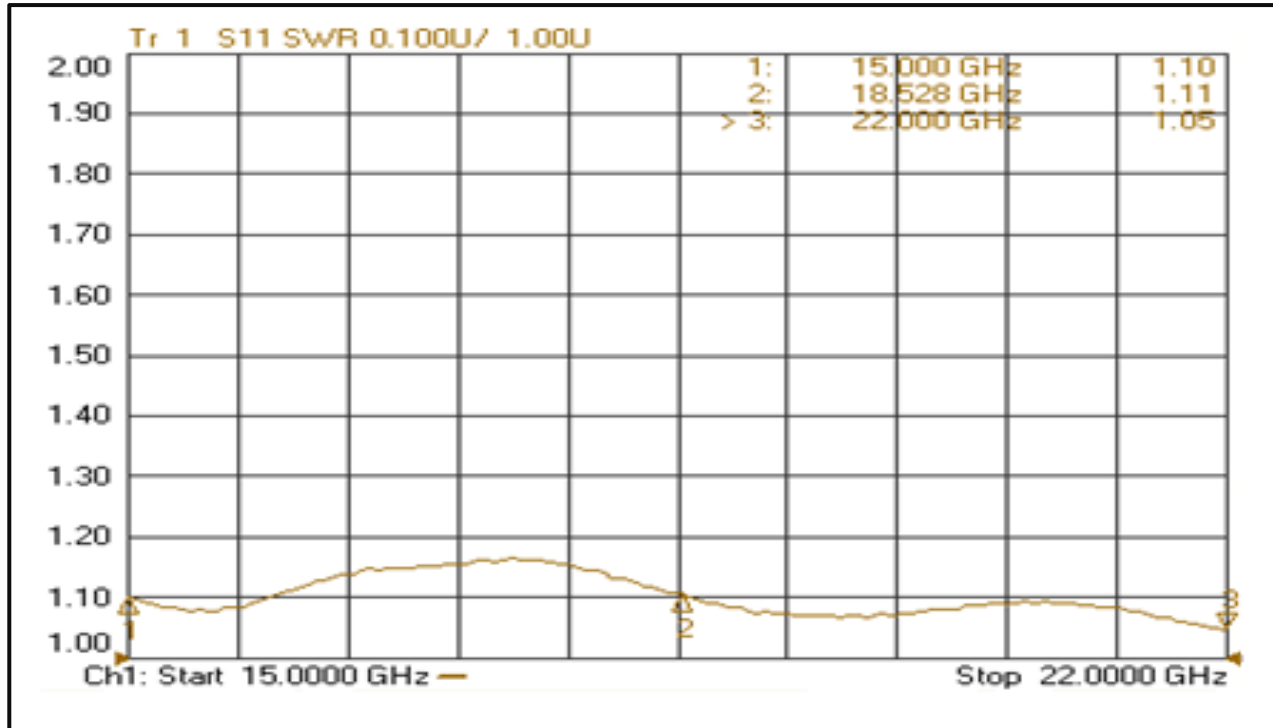

#### Output VSWR

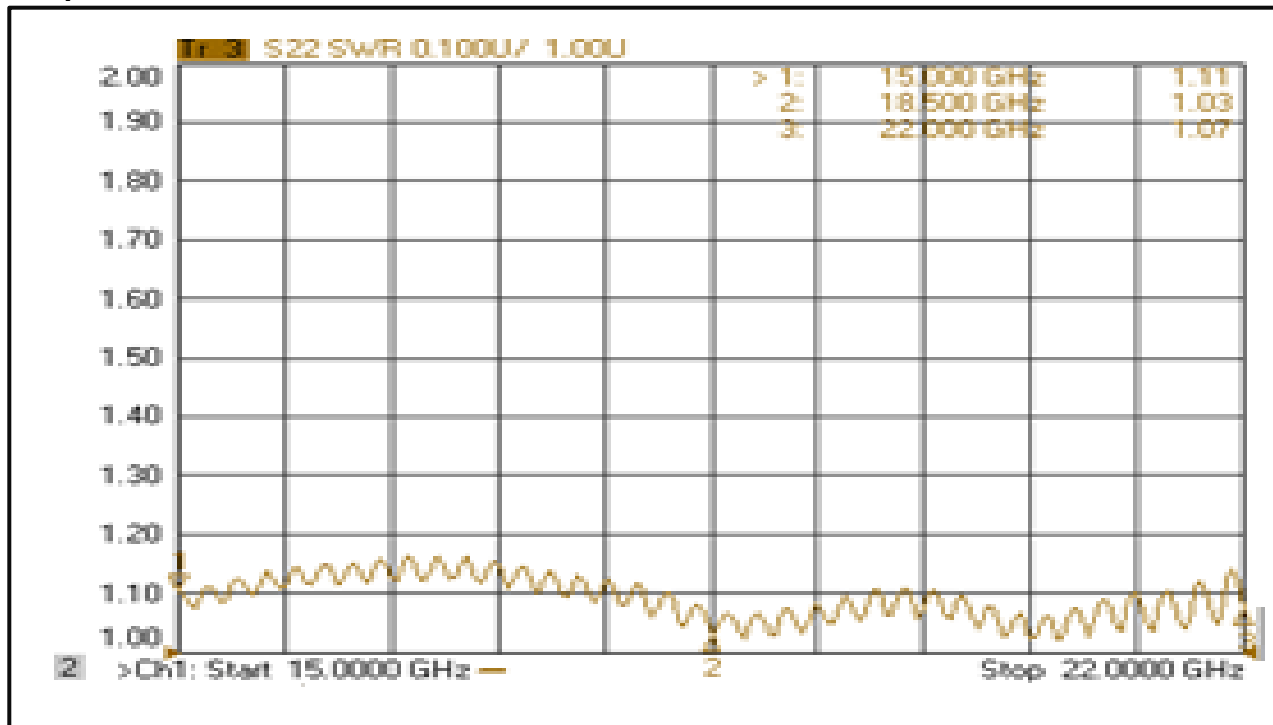



**Outline Drawing:**

All Dimensions in mm

20dB Model

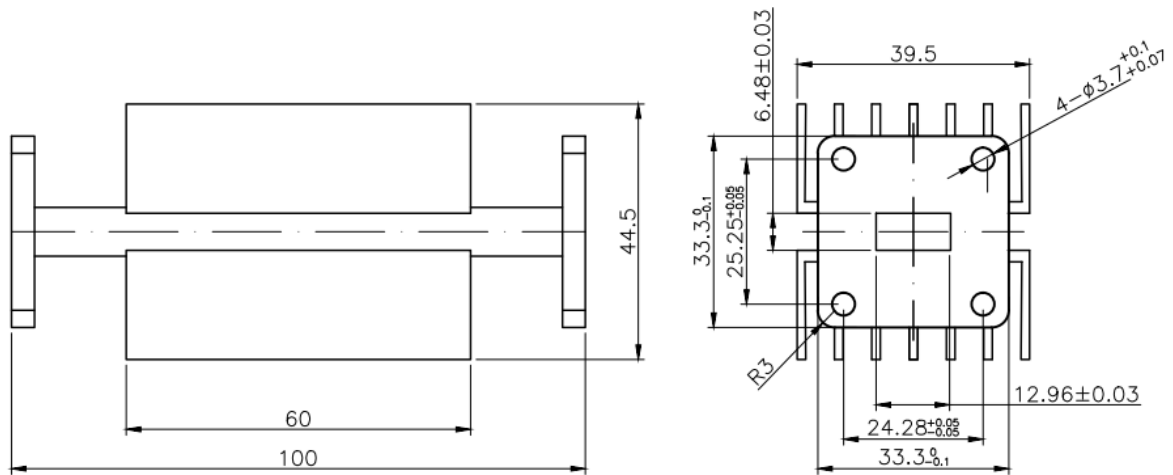

40dB Model

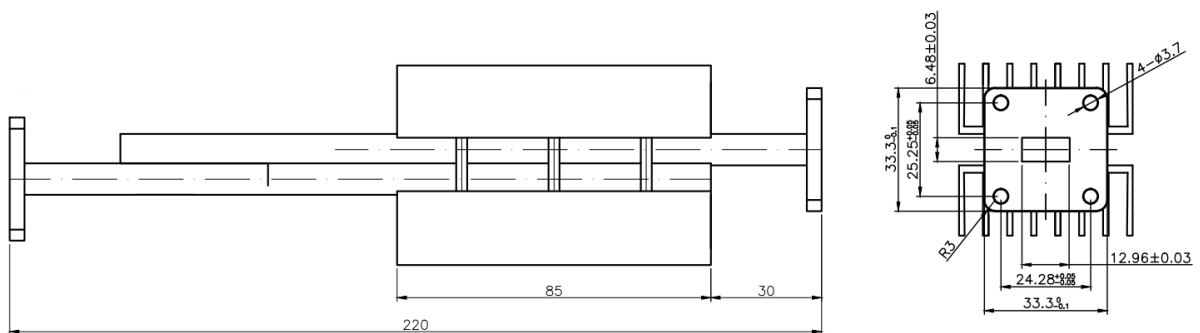

Note: Other attenuation values may have a different mechanical outline.

**Important Notice**

The information contained herein is believed to be reliable. RF-Lambda makes no warranties regarding the information contained herein. RF-Lambda assumes no responsibility or liability whatsoever for any of the information contained herein. RF-Lambda assumes no responsibility or liability whatsoever for the use of the information contained herein. The information contained herein is provided "AS IS, WHERE IS" and with all faults, and the entire risk associated with such information is entirely with the user. All information contained herein is subject to change without notice. Customers should obtain and verify the latest relevant information before placing orders for RF-Lambda products. The information contained herein or any use of such information does not grant, explicitly or implicitly, to any party any patent rights, licenses, or any other intellectual property rights, whether with regard to such information itself or anything described by such information. RF-Lambda products are not warranted or authorized for use as critical components in medical, life-saving, or life sustaining applications, or other applications where a failure would reasonably be expected to cause severe personal injury or death.

**WR51 Waveguide Attenuator 15 - 22GHz**