

7W ACPR Emission Compressed Linear Power Amplifier 0.7GHz-6GHz



Product Description

RFLUPA0706GBS is a Linear Power Amplifier with a frequency range of 0.7 to 6GHz.

The power output of this amplifier is 39dBm typical. The typical small signal gain is 40dB with a gain flatness of ± 1.5 dB. This power amplifier works with a +28 VDC power supply.

The working temperature of this product is between - 40°C and + 85°C.

Features

- Wideband Power Amplifier
- Small Signal Gain 40dB Typical
- High P1dB +37dBm Full Band
- Output Saturation Power 39dBm Typical
- Supply Voltage +28VDC
- 50 Ohm Matched Input / Output

Typical Applications

- Wireless Infrastructure
- Military and Aerospace Applications
- Test Instrumentation
- Radar Systems
- 5G Wireless Communications
- Microwave Radio Systems
- TR Modules
- Research and Development
- Cellular Base Stations

Electrical Specifications (T_A=+25°C)

Parameter	Min	Typ	Max	Min	Typ	Max	Units
Frequency Range	0.7		1	1		6	GHz
Gain	38	40		37	40		dB
Gain Flatness		± 1.5			± 1.5		dB
Gain Variation Over Temperature (-40°C to +85°C)		± 1.0			± 1.0		dB
Input Return Loss		13			13		dB
Output Power for 1 dB Compression (P1dB)	35	37		35	37		dBm
Saturated Output Power (Psat)		39			39		dBm
Isolation S12		-55			-55		dB
Supply Current (Vcc=+28V)		650	1500		650	1500	mA
Efficiency at P1dB		20			20		%
Weight	Net		0.4 Max.				lbs.
	Including Heat Sink		3.37 Max.				
Impedance	50						Ohms
Input / Output Connectors	SMA-Female(Input) – SMA-Female(Output)						
Package	Epoxy Sealed (Standard)						
	Hermetically Sealed (Optional)						

Absolute Maximum Ratings

Parameter	Rating
Operating Voltage	+24V~29V
*RF Input Power (RFIN)	+8dBm

Bias Up Procedure

1. Connect ground
2. Connect input and output with 50 Ohm source/load.
(In band VSWR < 1.9:1 or >10dB return loss.)
3. Connect positive supply and make sure power supply can handle max current.

Bias Down Procedure

1. Turn off power supply
2. Remove positive supply Connection
3. Remove RF Connection
4. Remove ground

Environmental Specifications and Test Standards

Parameter	Description
Operational Temperature	-40°C to +85°C (Case Temperature)
Storage Temperature	-50°C to +105°C
Thermal Shock	-40°C → +85°C (5 Cycles / 10 hours)
**Random Vibration	MIL-STD-202G Table 214-I, Test Condition Letter C 1.5 Hours Per Axis
High Temperature Burn In	Temperature +85°C for 72 Hours
Shock	1. Weight >20g, 50g half sine wave for 11ms, Speed variation 3.44m/s 2. Weight <=20g, 100g Half sine wave for 6ms, Speed variation 3.75m/s 3. Total 18 times (6 directions, 3 repetitions per direction).
Altitude	Standard: 30,000 Ft (Epoxy Sealed Controlled Environment) Optional: Hermetically Sealed (60,000 ft. 1.0 PSI min)
Hermetically Sealed (Optional)	MIL-STD-883 (For Hermetically Sealed Units)

*Maximum RF input power is set to assure safety of amplifier. Input power may be increased at own risk to achieve full power of amplifier. Please reference gain and power curves.

**For vibration testing details please see additional information section.

Typical Performance Plots

Gain@+25°C

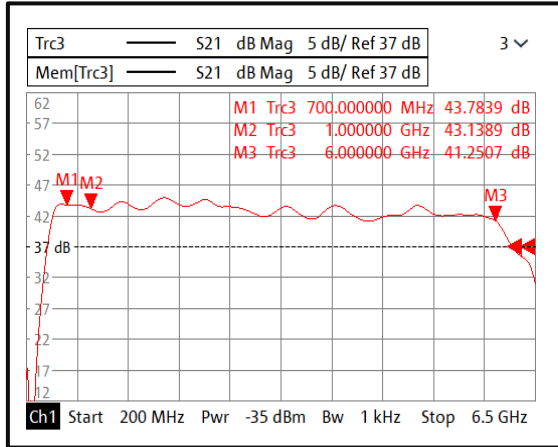

Input Return Loss@+25°C

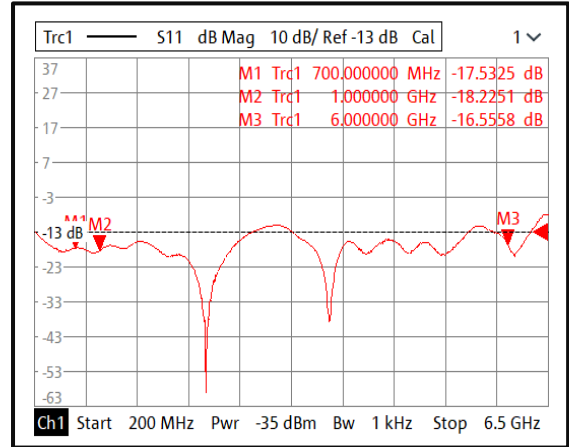

Isolation@+25°C

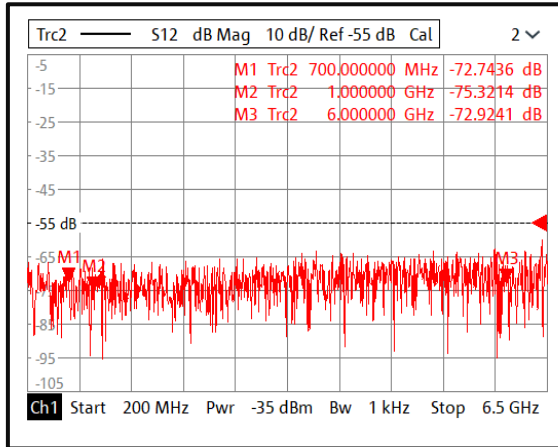

Gain@-40°C

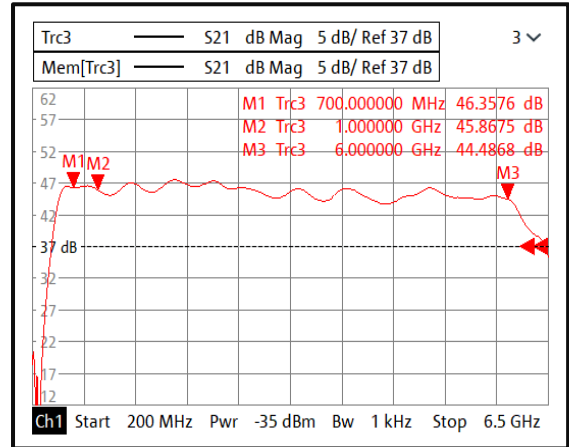

Input Return Loss@-40°C

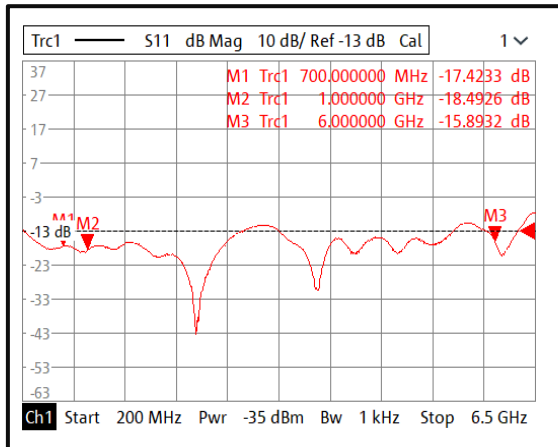

Isolation@-40°C

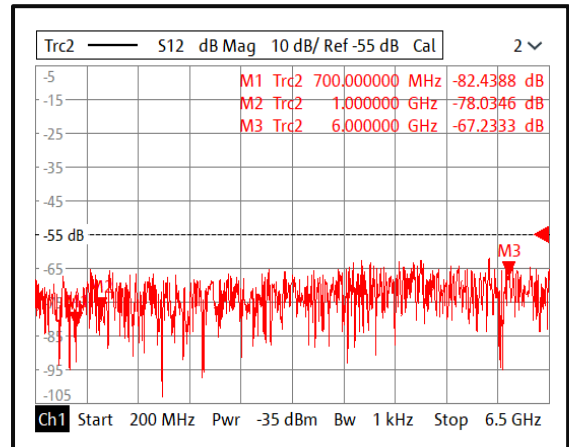

Note: Small signal VNA measurements include attenuators to protect equipment

Typical Performance Plots

Gain@+85°C

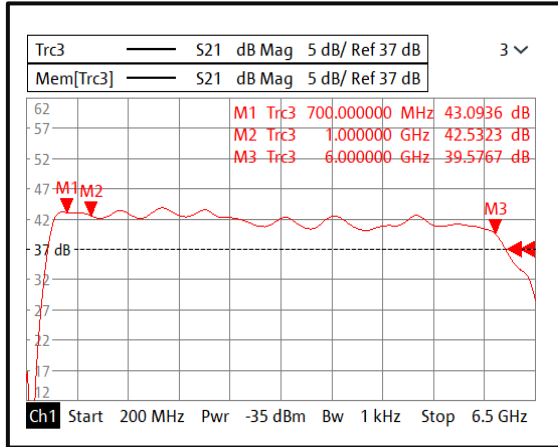

Input Return Loss@+85°C

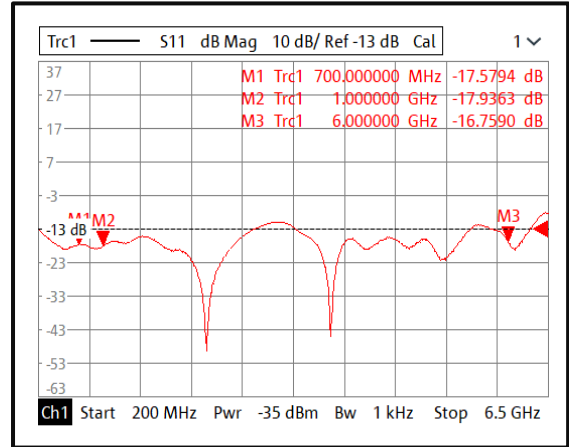

Isolation@+85°C

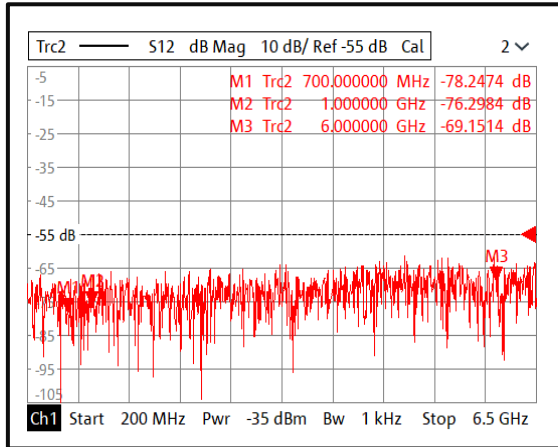

Note: Small signal VNA measurements include attenuators to protect equipment

Typical Performance Plots

Gain vs. Output Power CW

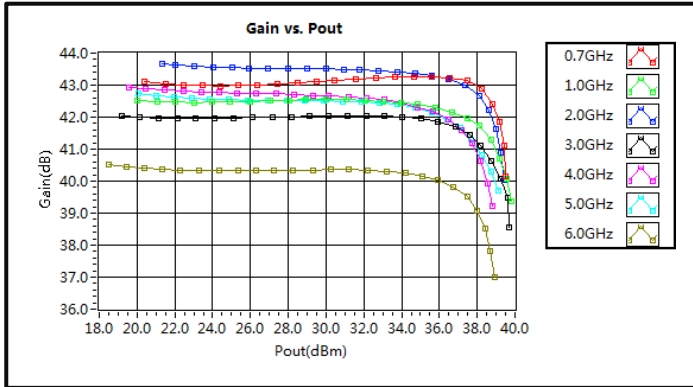

PndB vs. Frequency CW

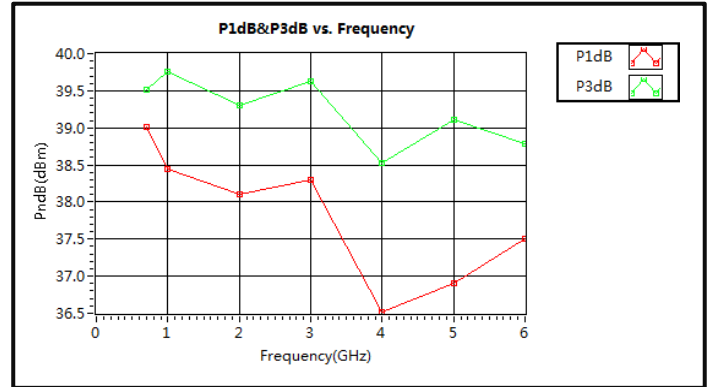

Power Added Efficiency CW

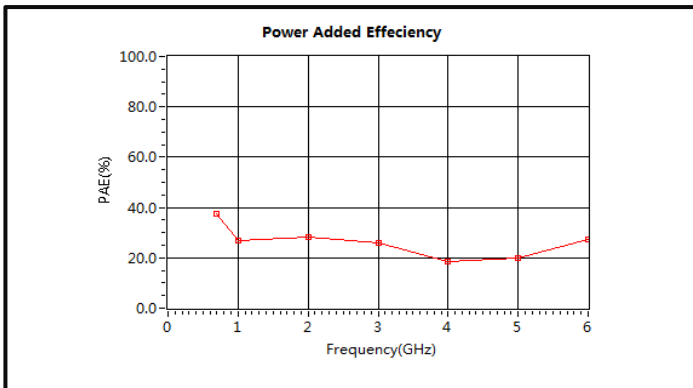

Saturation Power vs. Frequency CW

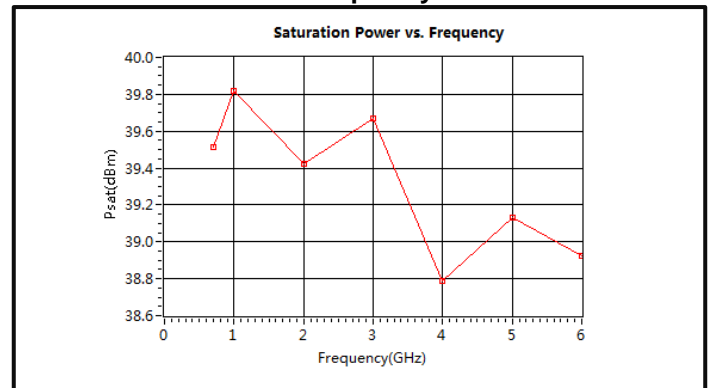

Pout vs. Pin

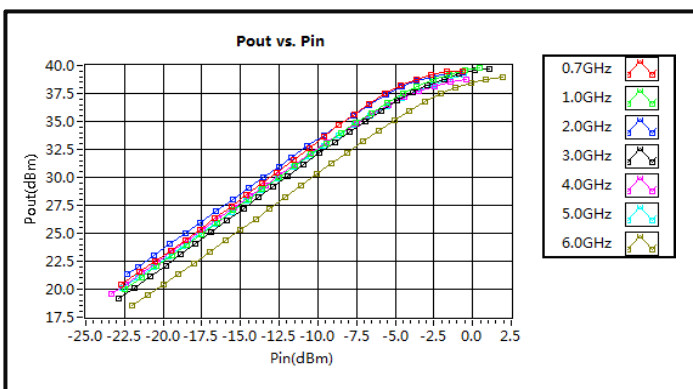

Current vs. Pout

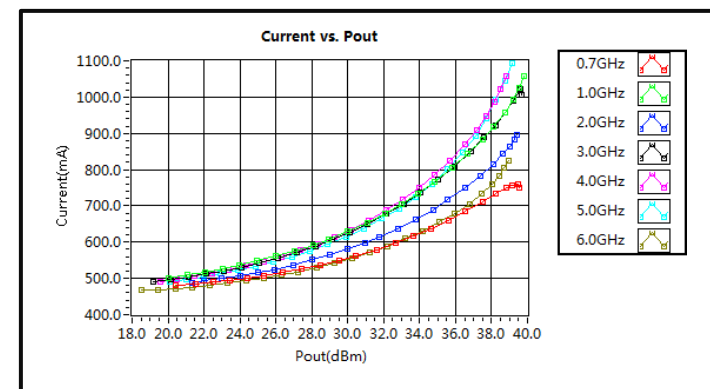

Typical Performance Plots

Left IM3 vs. Pout

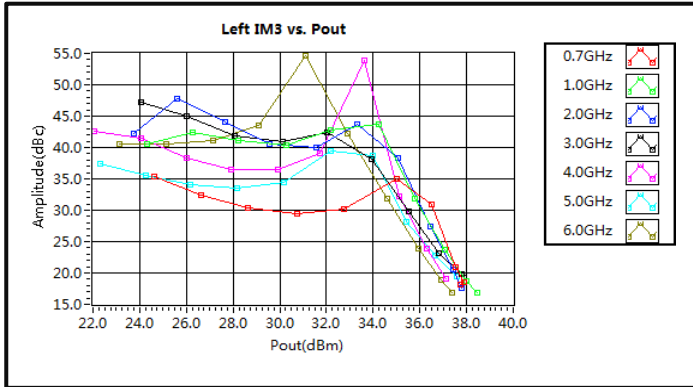

Right IM3 vs. Pout

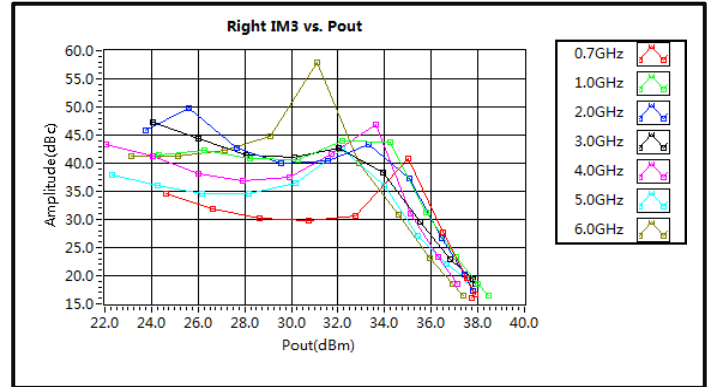

Delta IM3 vs. Pout

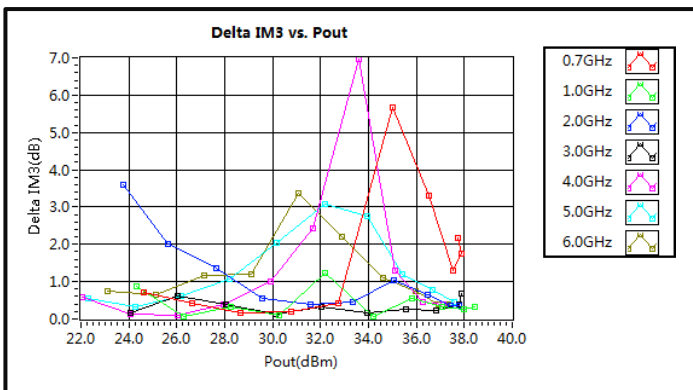

Note: IM3 test performed with 1MHz tone spacing

Outline Drawing

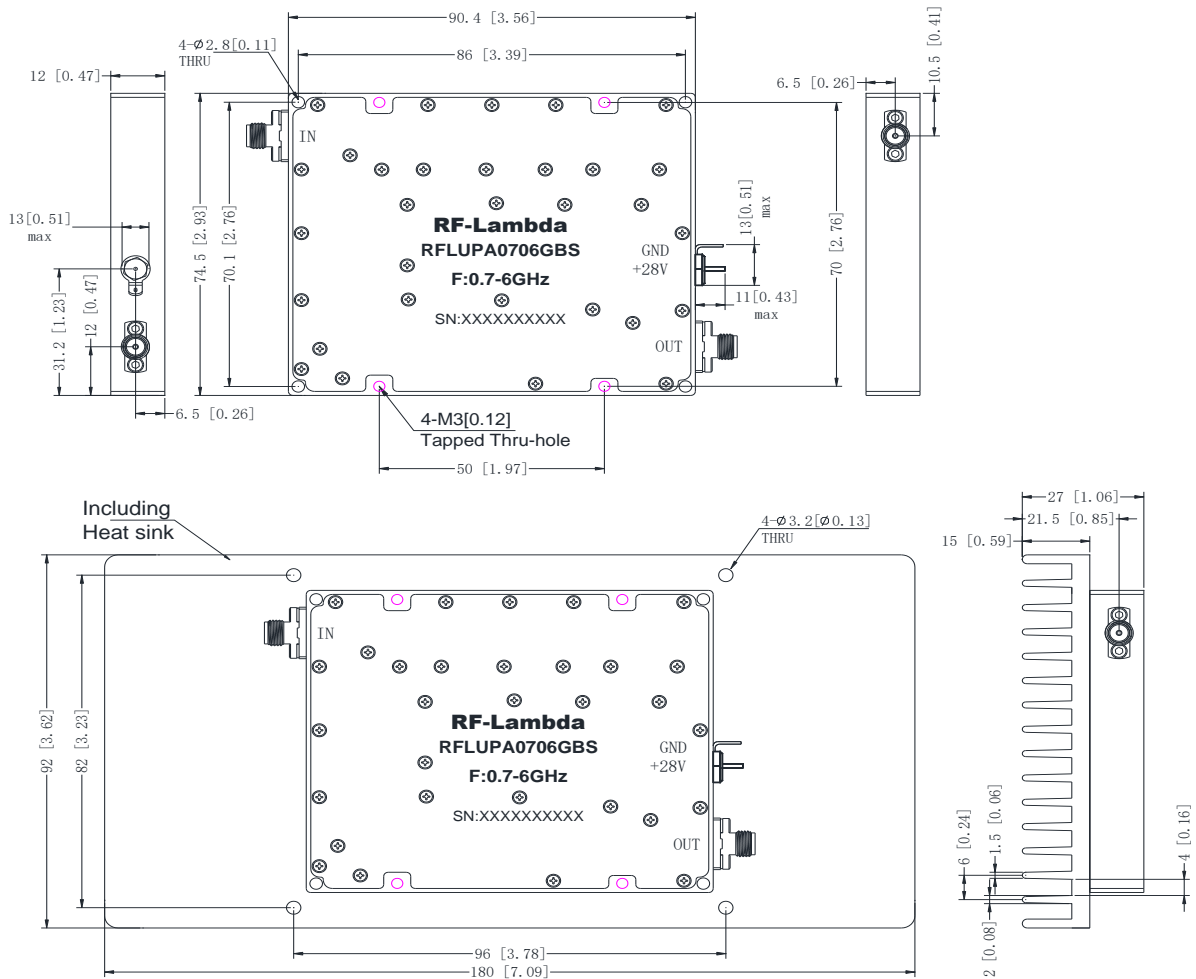

Notes:

1. Package Material: Aluminum
2. Finish: Nickel Plated
3. All dimensions are in millimeters [inches].
4. Tolerances ± 0.2 [0.008] unless otherwise specified(Excl Heat Sink).
5. Heat sink required during operation (sold separately). Matching heatsink is listed on our website. If customer would like to use their own cooling method, please make sure the amplifier will operate under the specs that listed in page 2 of this datasheet.
6. Standard torque wrench must be used to secure RF connectors.

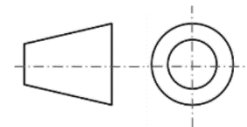

Additional Information

Documentation	Webpage
ESD Policy	https://rflambda.com/pdf/rflambda_esd_control.pdf
Heatsink Lookup Specifications	https://rflambda.com/search_heatsink.jsp
Connector Torque Specifications	https://www.rflambda.com/pdf/Torque_Specifications.pdf
Random Vibration Test Standard	https://www.rflambda.com/pdf/rflambda_random_vibration_MIL-STD-202G.pdf

Ordering Information

Part Number	Modification	Description
RFLUPA0706GBS	Standard	0.7GHz-6GHz Power Amplifier

Amplifier Use

Ensure that the amplifier input and output ports are safely terminated into a proper 50 ohm load before turning on the power. Never operate the amplifier without a load. A proper 50 ohm load is defined as a load with impedance less than 1.9:1 or return loss larger than 10dB relative to 50 Ohm within the specified operating band width.

Power Supply Requirements

Power supply must be able to provide adequate current for the amplifier. Power supply should be able to provide 1.5 times the typical current or 1.2 times the maximum current (whichever is greater).

In most cases, RF - Lambda amplifiers will withstand severe mismatches without damage. However, operation with poor loads is discouraged. If prolonged operation with poor or unknown loads is expected, an external device such as an isolator or circulator should be used to protect the amplifier.

Ensure that the power is off when connecting or disconnecting the input or output of the amp.

Prevent overdriving the amplifier. Do not exceed the recommended input power level.

Adequate heat-sinking required for RF amplifier modules. Please inquire.

Amplifiers do not contain Thermal protection, Reverse DC polarity or Over voltage protection with the exception of a few models. Please inquire.

Proper electrostatic discharge (ESD) precautions are recommended to avoid performance degradation or loss of functionality.

What is not covered with warranty?

Each RF - Lambda amplifier will go through power and temperature stress testing. Since the die, ICs or MMICs are fragile, these are not covered by warranty. Any damage to these will NOT be free to repair.

Important Notice

The information contained herein is believed to be reliable. RF-Lambda makes no warranties regarding the information contained herein. RF-Lambda assumes no responsibility or liability whatsoever for any of the information contained herein. RF-Lambda assumes no responsibility or liability whatsoever for the use of the information contained herein. The information contained herein is provided "AS IS, WHERE IS" and with all faults, and the entire risk associated with such information is entirely with the user. All information contained herein is subject to change without notice. Customers should obtain and verify the latest relevant information before placing orders for RF-Lambda products. The information contained herein or any use of such information does not grant, explicitly or implicitly, to any party any patent rights, licenses, or any other intellectual property rights, whether with regard to such information itself or anything described by such information. RF-Lambda products are not warranted or authorized for use as critical components in medical, life-saving, or life sustaining applications, or other applications where a failure would reasonably be expected to cause severe personal injury or death.