

200W HIGH POWER FIXED ATTENUATOR

--- RFS200G4A

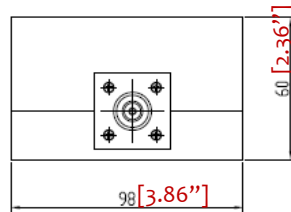
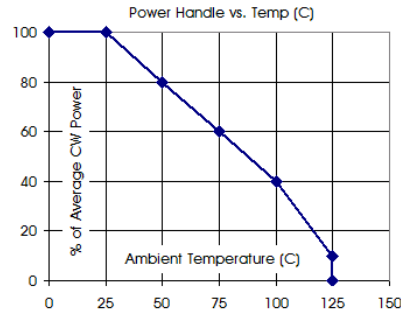
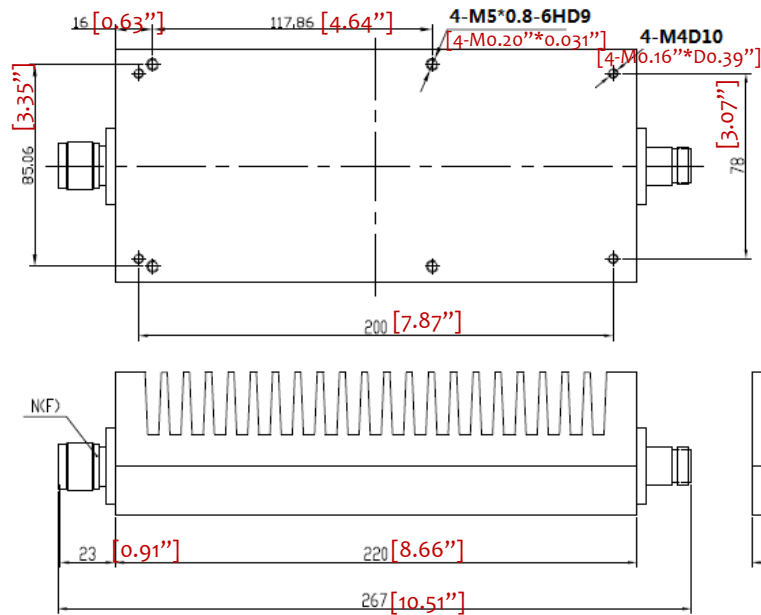

2.0 Environment specifications	
2.1	Operation Temp. -40°C~+85°C
2.2	Storage Temp. -55°C~+125°C
2.3	Altitude 42000 ft
2.4	Vibration 10g rms (15 degree 2KHz)
2.5	Humidity 100%RH at 35c, 95%RH at 40 deg c
2.6	Shock 20G for 11msec
2.7	Cooling FAN required for long time operation

3.0 Electrical Specifications								
PN	Frequency (GHz)	VSWR (max.)	Attenuation Accuracy (dB)				Power (CW)	Peak Power (KW)
			10	20	30	40-50		
RFS200G4A	DC-4GHz	1.4	±1.5	±1.5	±1.0	±1.0	200	10KW

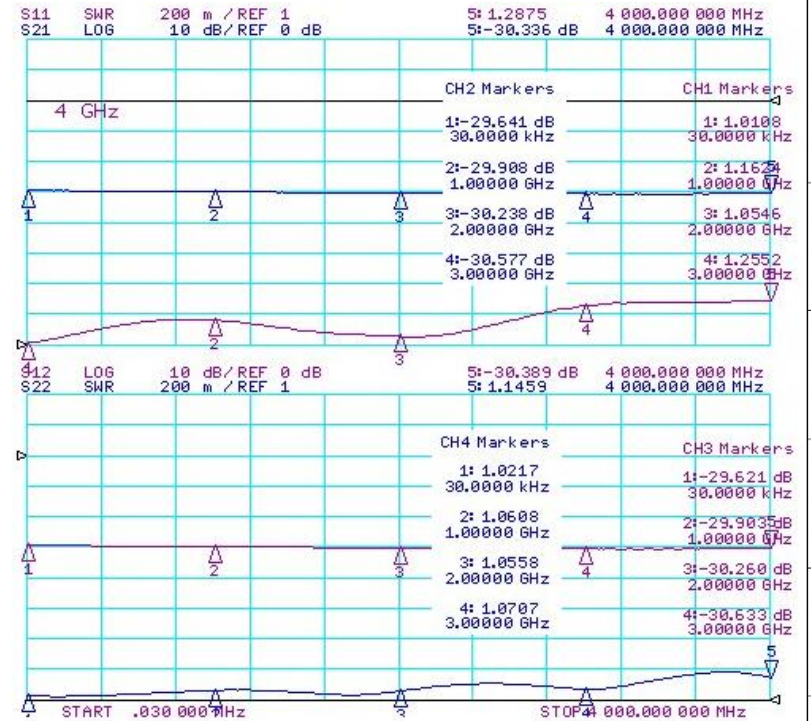

1.0 Mechanical Specifications	
1.1	Connector N or 7/16 (Male or Female)
1.2	Size See Drawing
1.3	Weight 2.8kg
1.4	External Finish Body painted with black epoxy enamel

PAGE 1 OF 1	DATE MAY 6 th 2000
<small>PROPRIETARY INFORMATION THE INFORMATION CONTAINED IN THIS DOCUMENT IS THE PROPERTY OF RF-LAMBDA EXCEPT AS SPECIFICALLY AUTHORIZED IN WRITING BY RF-LAMBDA. THE HOLDER OF THIS DOCUMENT SHALL KEEP ALL INFORMATION CONTAINED HEREIN CONFIDENTIAL AND SHALL PROTECT SAME IN THE WHOLE OR IN PART FROM DISCLOSURE AND DISSEMINATION OF ALL THIRD PARTIES AND SHALL USE SAME FOR OPERATING AND MAINTENANCE PURPOSES ONLY</small>	DESIGN RFPFC RF-LAMBDA RFPFC CAD MODEL REVISION 10 ASSEMBLY REVISION VS52 ASSEMBLY NAME RFLVR07 DRAWING NUMBER D05-A
RFS200GXA HIGH POWER ATTENUATOR	
www.rflambda.com	
RF-LAMBDA	SIZE LT SHEETS 1 OF 1